

State Project No. 40-141 Swing Bridge Rehabilitation



Middlesex Chamber of Commerce Meeting

August 26, 2021

8:00 am

CONNECTICUT DEPARTMENT OF TRANSPORTATION



CTDOT Project Team



Eileen Ego, P.E.
District Engineer – CTDOT
District 2 Construction



Bart Sweeney, P.E.
Div. Chief of Bridges -
CTDOT



Lou Bacho, P.E.
Principal Engineer - CTDOT



Derick Lessard, P.E.
Supervising Engineer - CTDOT



John Deliberto, P.E.
Assistant District Engineer -
CTDOT



Jonathan Kang, EIT
Project Engineer - CTDOT



Tracey Brais, P.E.
Project Engineer - CHA
CONNECTICUT DEPARTMENT OF TRANSPORTATION

Designer of Record
Hardesty & Hanover,
Steven Harlacker, PE, SE
Kimberly Smith, PE



Project 40-141 - Rehabilitation of East Haddam Swing Bridge



Adjacent Projects in Town of Haddam



Adjacent Projects in Town of East Haddam



Project 40-141 - Rehabilitation of East Haddam Swing Bridge

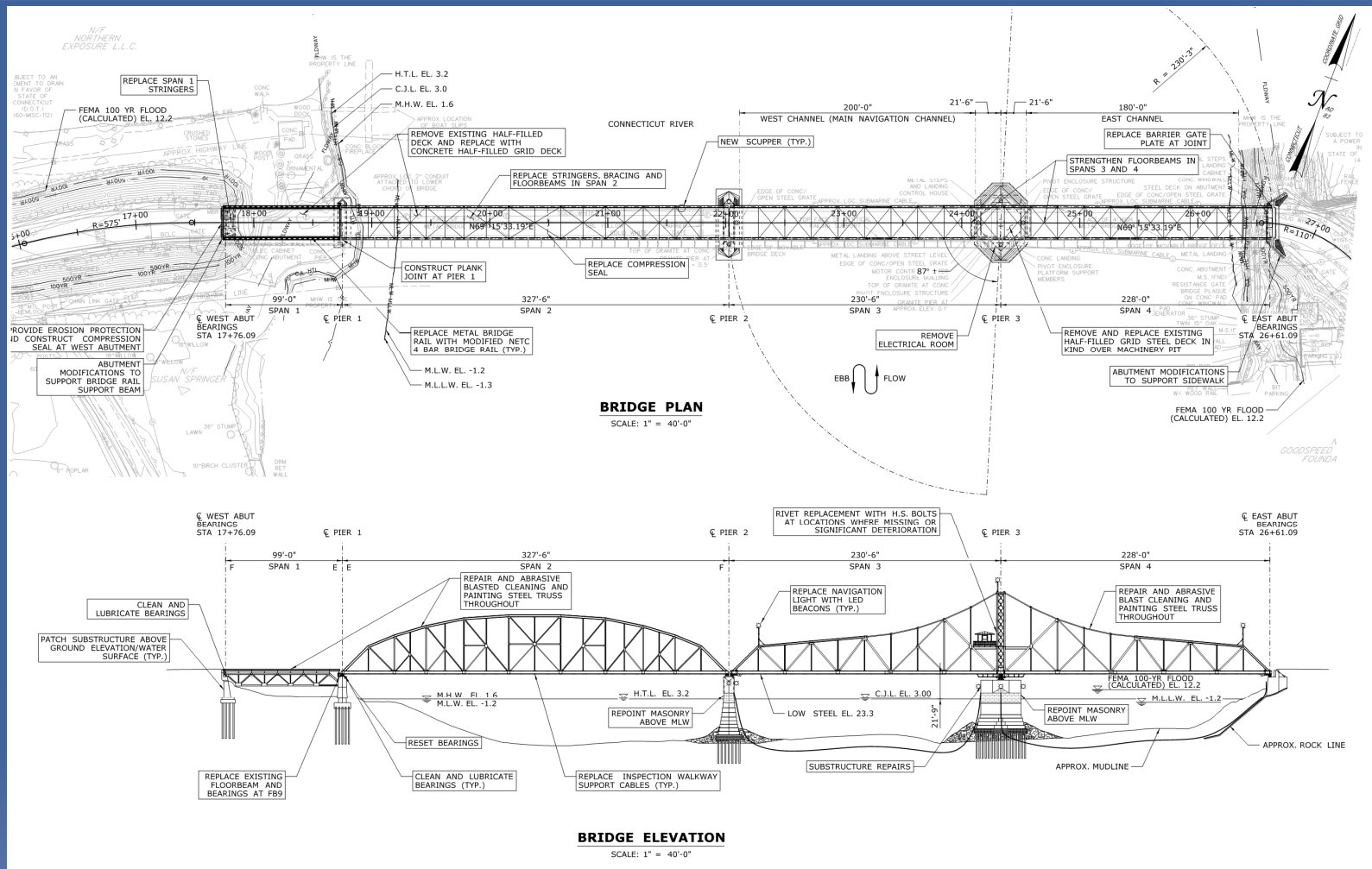

Project Info

- Construction Cost Estimate: \$58.2 Million
- Final Design is complete (Addendum anticipated to incorporate any necessary changes)
- 3 Construction Seasons (Anticipated Spring 2022 to Fall 2024)
- No winter shutdowns



Public Outreach to Date

Date	Meeting Description				
10/19/2016	Initial Bridge Sidewalk Discussion				
7/13/2017	Town Roads Meeting				
9/28/2017	Middlesex Chamber of Commerce Meeting				
10/2/2017	Public Information Meeting				
5/12/2020	Town/Stakeholder Review Meeting (to discuss revised M&PT/63-hr closures)				
9/9/2020	Haddam Approach Sidewalk Design Meeting				
2/1/2021	Meeting with East Haddam Small Businesses, hosted by Representative Haines				
3/31/2021	Meeting with Local Businesses, requested by both First Selectmen				
7/29/2021	Follow-up meeting with Local Businesses, requested by both First Selectmen				
8/26/2021	Middlesex Chamber of Commerce Meeting				



Project 40-141 Construction Schedule

****Subject to Change Based on Contractor Means & Methods****

- At least 14 days' notice of all proposed closures will be provided.
- 63-Hour Closures (Sunday 10pm–Wed 1pm)
 - (25) allowed contractually
 - Span 1 work: (4) closures, Span 2 work: (19) closures, Approach Roadway work: (2) closures
- Alternating 1-Way Traffic (24 hrs/day)
 - (23) weeks allowed contractually (reduced from 35 weeks)
 - 17 consecutive weeks for mechanical/electrical (Dec. 2023 through Mar. 2024)
 - 6 weeks for retaining wall, abutment and sidewalk work (Nov. 15 through May 15)
 - Temporary signalization used to maintain traffic flow

Project 40-141 Construction Schedule

****Subject to Change Based on Contractor Means & Methods****

➤ Off-Peak Closures

- Allowable closure times based on traffic volumes and analyses
- Temporary alternating 1-way traffic will not be allowed during the following peak travel times:
 - Monday – Friday between 6am and 9am, 3pm and 6pm
 - Saturday and Sunday between 10am and 6pm
- Overnight closures will be allowed at the following off- peak times:

Day	Closure Window
Sunday	10pm – 6am
Monday	7pm – 6am
Tuesday	7pm – 6am
Wednesday	11pm – 6am
Thursday	11pm – 6am
Friday	11:30pm – 8am
Saturday	11:30pm – 8am



Project 40-141 Construction Schedule

****Subject to Change Based on Contractor Means & Methods****

- Anticipated Navigation Channel (within Span 3) closures:
 - Part of Dec. 2022 – Jan. 2023 (when installing sub cable)
 - Periodically between April and October
 - Temporary alternate channel will be provided under Span 4

- Anticipated Swing Span Operation Outage:
 - No openings to boat traffic from December 2023 through March 2024 (for mech/elect. work)
 - Bridge opening restrictions are proposed at peak traffic hours to minimize traffic back-ups (7am, 4pm, 5pm and 6pm)
 - Navigation channel will be open to smaller vessels that can pass under bridge

Questions from the July 29, 2021 Meeting

1. Will we be coordinating with Waze and Google Maps so that closures show up on the driving apps?
 - Yes, closures will be registered into these mobile apps when they occur. Additionally, closures will be posted to:
 - Project Website (<https://www.easthaddamswingbridgeproject.com>) Sign up for our mailing list on website!
 - CT Travel Smart Website (cttravelsmart.org)
 - Twitter (@CTDOT_EHaddamBr)
 - Facebook (@CTdotEHaddamBr)
2. Will we be extending the operational hours of the Chester-Hadlyme Ferry during closures?
 - Going through the approval process. Increase services to:
 - Monday-Friday 5am-10pm
 - Season extended to March through December (weather permitting)
3. What is the status on the alternating one-way traffic analysis?
 - 2 minute average delay
 - 10 minutes for queue to clear
 - Bridge openings proposed not occur during peak hours (7am, 4pm, 5pm and 6pm)
 - Letter will be sent to each First Selectmen in the near future.

Questions from the July 29, 2021 Meeting

4. Where will we be placing variable message signs (VMS) and advance warning signs to notify drivers of the closures?



Project 40-141 Detour Route

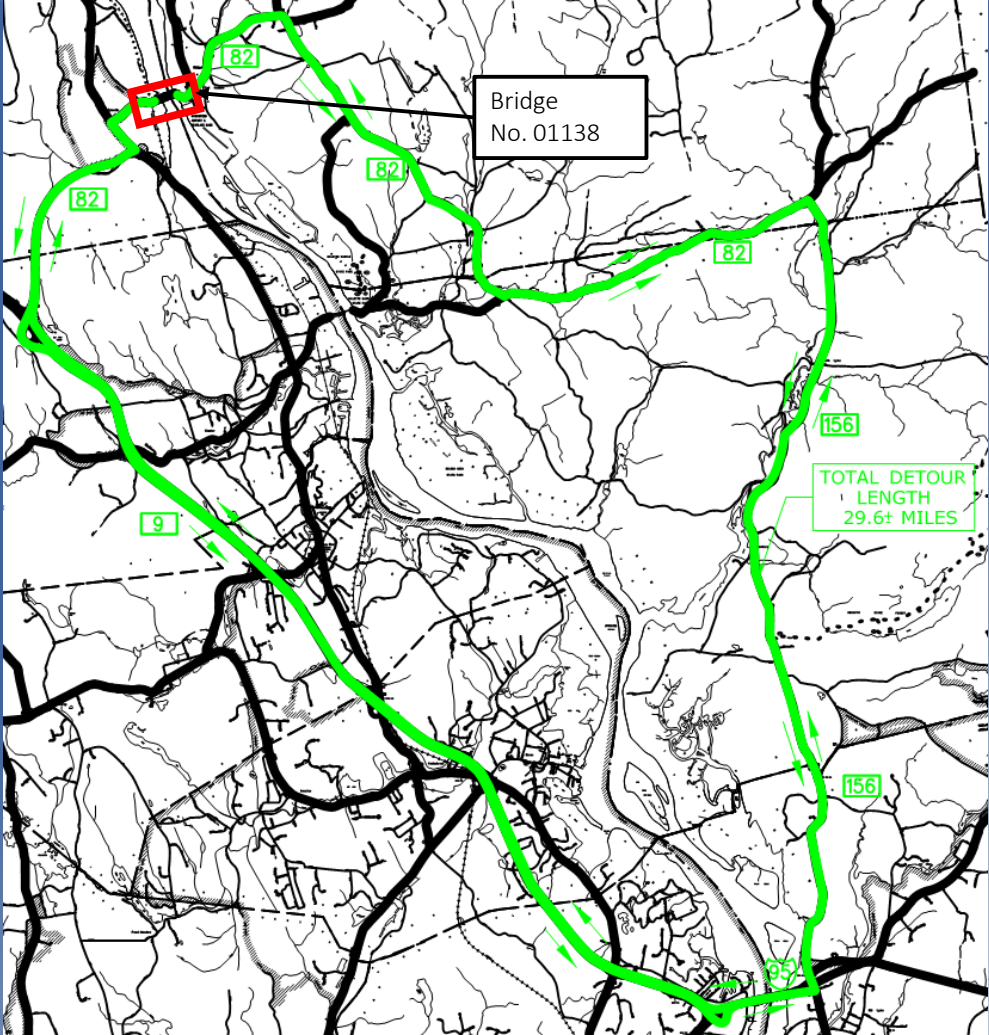

Project 40-141 Bridge Closure Communications

➤ Advance Warning Signs

- On Route 151 at intersection with Route 82
- On Route 82 at intersection with Route 154
- Portable variable message signs (VMS) at:
 - Route 9 SB in Cromwell
 - I-95 at Exits 67 and 70
 - Bridge Approaches
 - Use of Existing VMS

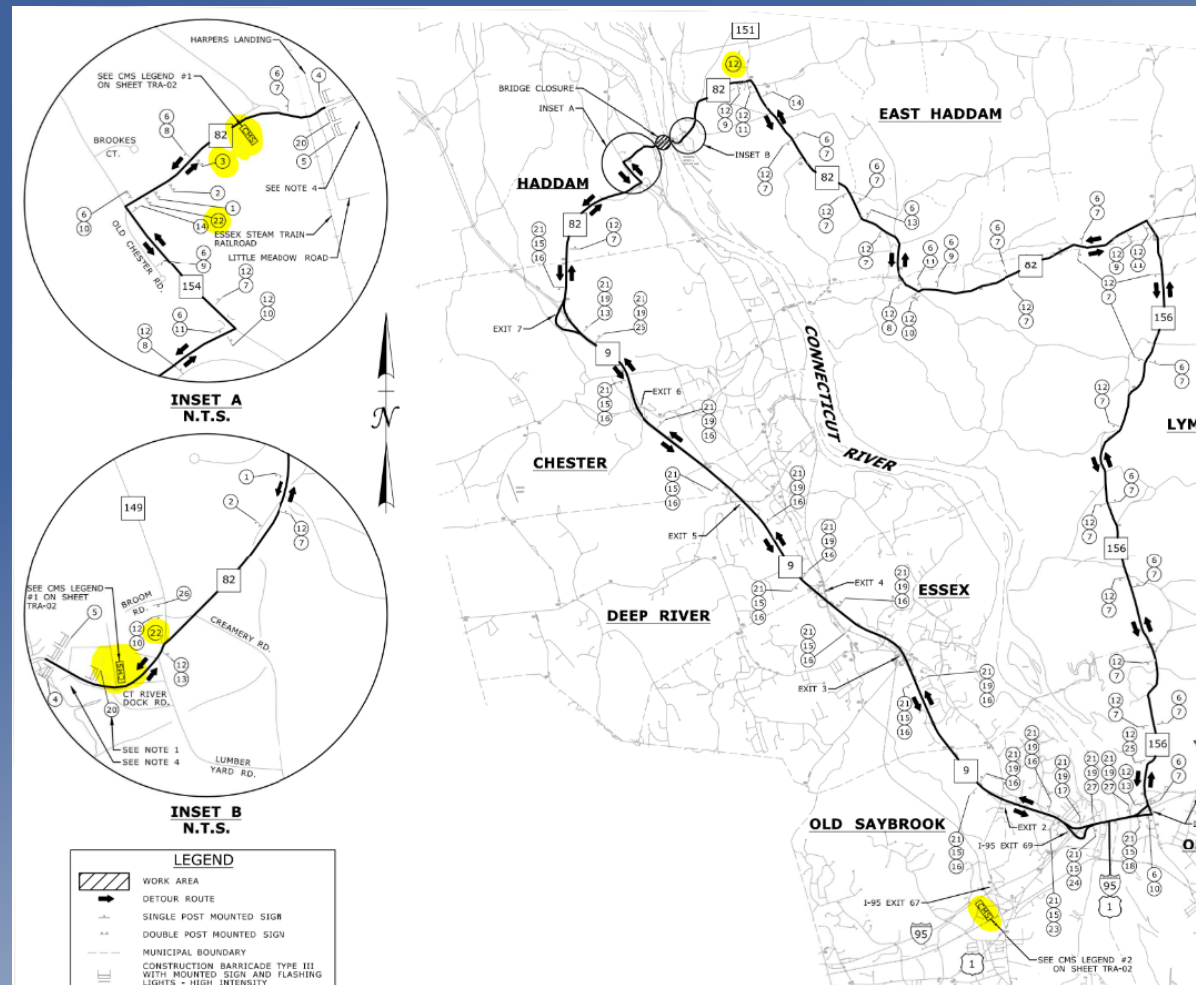

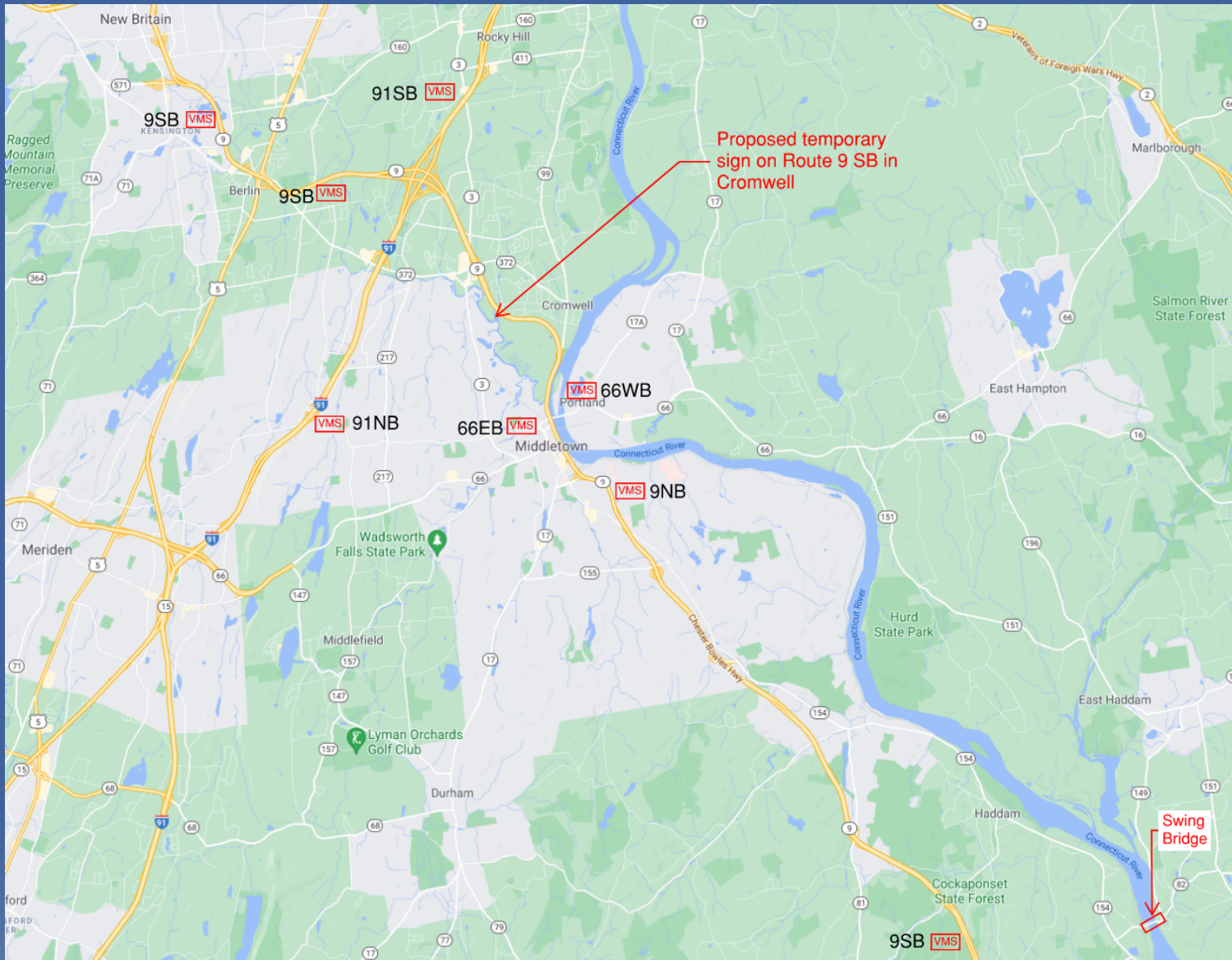

ATION



Questions from the July 29, 2021 Meeting

5. Can we restrict the Contractor to only utilize the 63-hour closures between November 1st-April 30th?
 - Unfortunately not, restricting the Contractor to this time frame would:
 - Unrealistically restrict the Contractor when combined with regulated restrictions
 - Extend the duration of construction into a 4th season, with high risk of rolling into a 5th season
 - Quality of work would be jeopardized
 - Certain work activities that require a 63-hour closure are weather dependent and require warm weather (ie. paving)
 - However, incentives and disincentives will be included in the contract.



Project 40-141 Incentives/Disincentives

- Disincentives Applied (Contractor will be charged a fee) :
 - For each hour that bridge is not open to two lanes after any allowable lane/bridge closure
 - For each day after March 31st that the swing span cannot open for the passage of marine traffic.

- Incentives Applied (Contractor will receive additional payment):
 - For each eliminated 63-hour closure (up to 5 eliminated closures).
 - For each 63-hour closure performed between November 1st and April 30th.



Questions

- When asking a question please provide your name and affiliation.
- Additional questions after the meeting? Feel free to contact

Project Email Address: DOTProject40-141@ct.gov

Derick Lessard: Derick.Lessard@ct.gov

